

**SCHEDULE OF DOORS -**

SL.NO	MKD	SILL	LINTEL	SIZE
1.	D	-	2150	1500X2150
2.	DA	-	2150	1200X2150
3.	D1	-	2150	1100X2150
4.	D2	-	2150	1000X2150
5.	D3	-	2150	900X2150
6.	D4	-	2150	750X2150
7.	D5	-	2150	600X2150
8.	D1A	150	2000	1100X2000
9.	SD1	-	2150	2400X2150
10.	SD2	-	2150	2250X2150
11.	SD3	-	2150	1800X2150
12.	SD4	-	2150	1400X2150
13.	DW1	-	2150	4000X2150
14.	DW2	-	2150	3500X2150
15.	DW3	-	2150	3150X2150
16.	DW4	-	2150	2400X2150
17.	DW5	-	2150	2250X2150
18.	DW6	-	2150	1900X2150
19.	DW7	-	2150	1500X2150
20.	DW8	-	2150	1450X2150
21.	DW9	-	2150	1350X2150
22.	V	AS/ELEVATION		
23.	C.G.	AS/ELEVATION		
24.	F.C.D.	2150	1100X2150	
25.	F.C.D.1	-	2150	1200X2150

  

**SCHEDULE OF WINDOWS -**

SL.NO	MKD	SILL	LINTEL	SIZE
1.	W1	350	2150	1500X1800
2.	W2	350	2150	1200X1800
3.	W3	1100	2150	1050X1050
4.	W4	350	2150	850X1800
5.	W5	1250	2150	600X900
6.	SW	350	2150	1200X1800

**CO-ORDINATE OF SALBULLAH PILINGS & PROPERTY DEMARCATION**

SL NO.	Latitude in Deg.Min.Seconds (North)	Longitude in Deg.Min.Seconds (East)
Point 1	22-37-32.54	088-21-59.95
Point 2	22-37-32.92	088-21-59.85
Point 3	22-37-33.51	088-21-59.61
Point 4	22-37-34.09	088-21-59.35
Point 5	22-37-34.29	088-21-59.21
Point 6	22-37-34.81	088-21-59.16
Point 7	22-37-35.02	088-21-59.05
Point 8	22-37-35.51	088-21-58.97
Point 9	22-37-35.88	088-21-58.78
Point 10	22-37-36.19	088-21-58.63

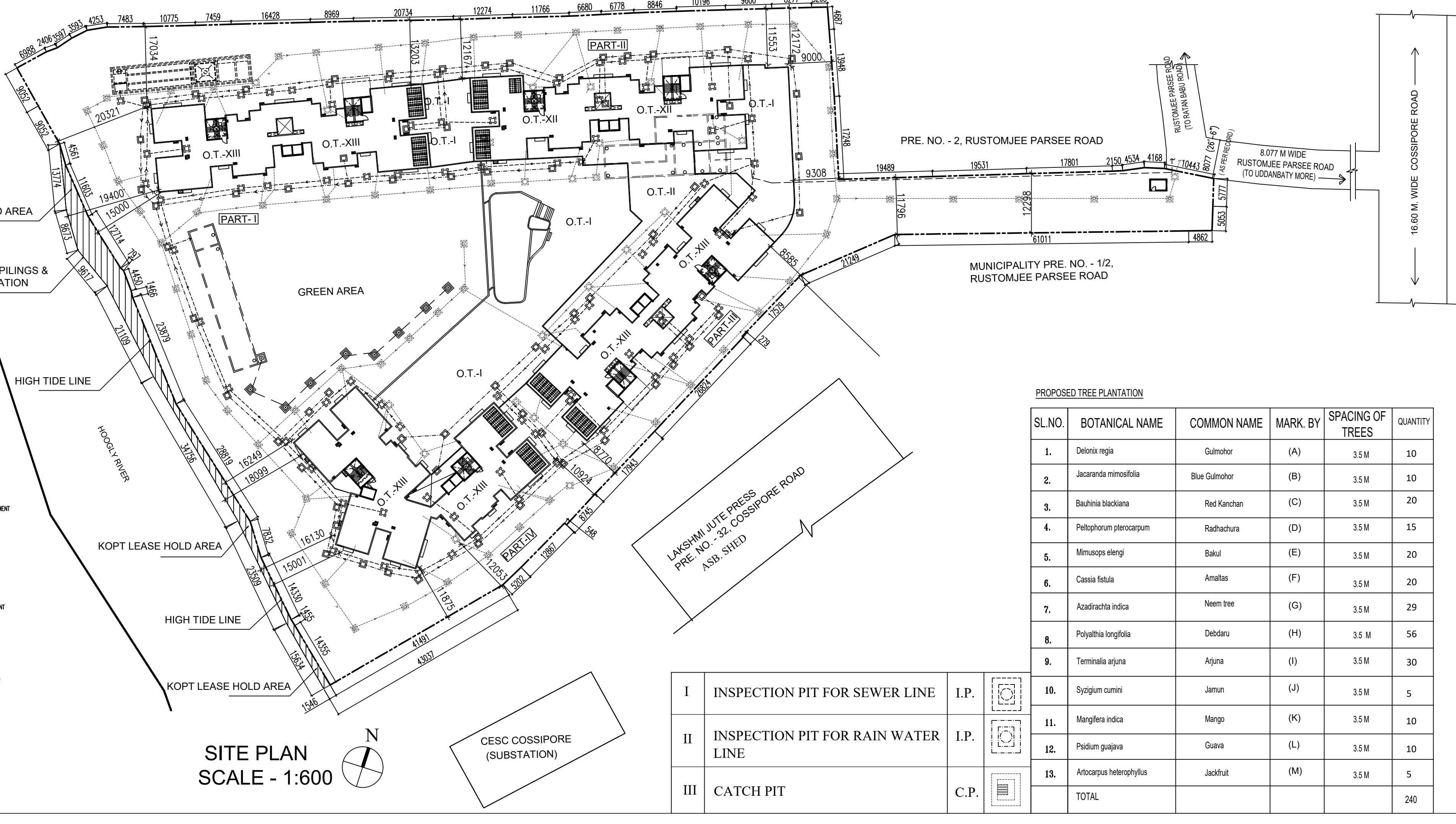
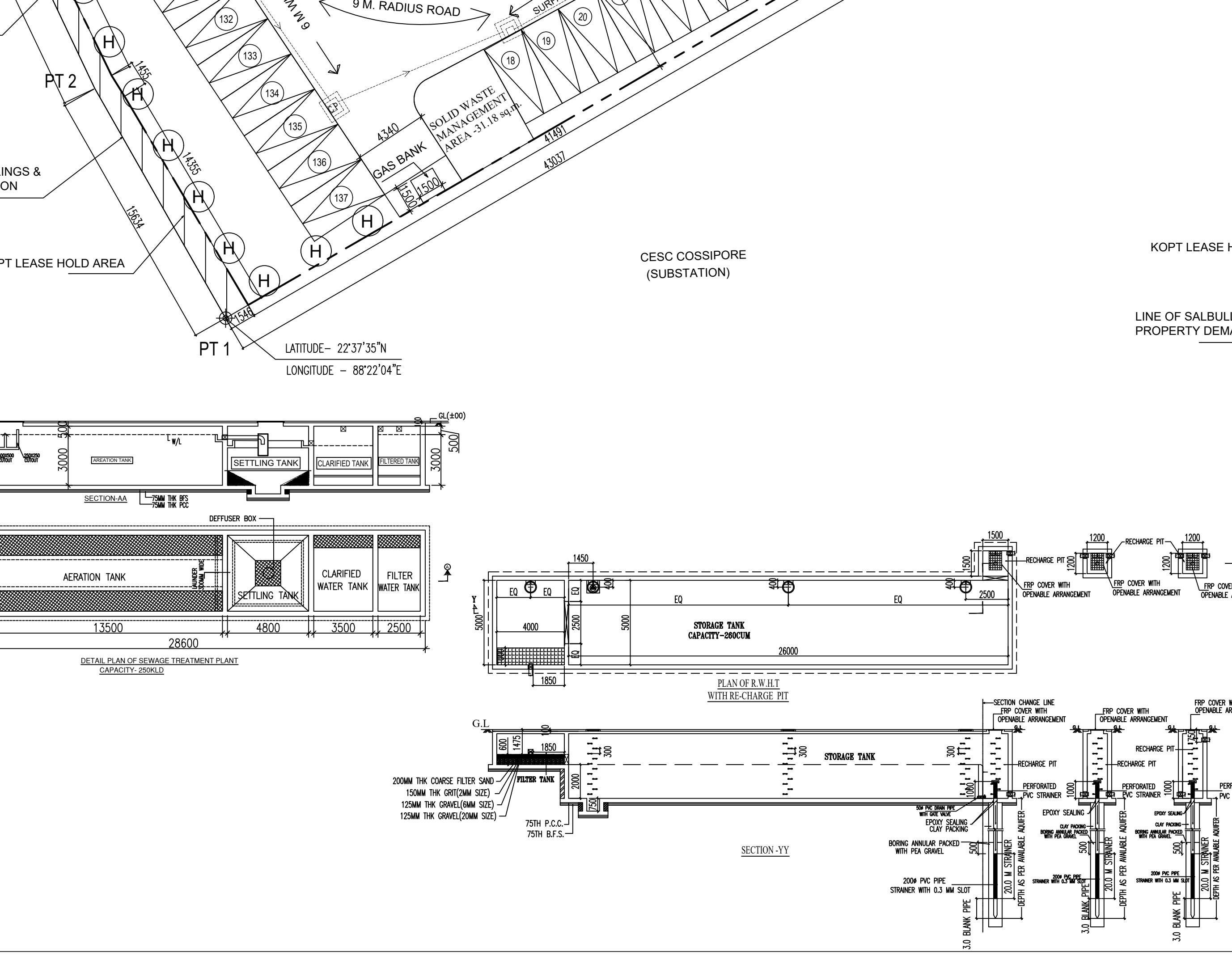

**A. DETAIL OF PLAN PROPOSAL -**

1. ADDRESS NO. - 1180000015
2. KOPT NO. NO. ADM. /ASA /ANTR/KS/REG/2.2. DATED. - 16-08-2016
3. ULCR CLEARANCE NO. - 209 /UL /XV /24/2014. DATED. - 22-10-2014
4. PROPOSED NO. OF PARKING - 388 NOS.
5. (i) LAND AREA - 18900.37 SQ.M. (270 K. - 00 CH. - 00 S.F.T.)
6. (ii) PHYSICAL LAND AREA - 16302.43 SQ.M. (246 K. - 09 CH. - 38.56 S.F.T.)
7. (iii) KOPT AREA - 285.00 SQ.M. (4 K. - 84 CH. - 7.71 S.F.T.)
8. (iv) PHYSICAL LAND AREA EXCLUDING KOPT AREA - 16017.43 SQ.M. (240 K. - 05 CH. - 30.85 S.F.T.)
9. (v) NO. OF STOREY - G+XII & PARTLY G+XIII
10. (vi) NO. OF 2BHK FLAT - 136 NOS.
11. (vii) NO. OF 3BHK FLAT - 233 NOS.
12. (viii) TOTAL NO. OF TENEMENTS - 369 NOS.
13. (ix) SIZES OF TENEMENTS -
14. (a) (BELOW 100 SQ.M.) - 150 NOS.
15. (b) (100-200 SQ.M.) - 233 NOS.

**B.**

1. PROPOSED GROUND COVERED - 5885.70 SQ.M. (36.61 %)
2. F.A.R. CONSUMED - 2.192
3. TOTAL SERVICE AREA (IN GR. FLR.) - 832.56 SQ.M.
4. TOTAL CAR PARKING AREA (IN GR. FLR.) - 546.25 SQ.M.
5. TOTAL NO. OF CAR PARKING -
6. (i) REQUIRED NO. OF PARKING - 381 NOS.
7. (ii) PROVIDED NO. OF PARKING - 388 NOS.
8. (iii) NO. OF OPEN PARKING - 109 NOS.
9. (iv) NO. OF SHED COVER PARKING - 28 NOS. MECHANICAL PARKING
10. (v) NO. OF COVERED PARKING - 271 NOS. (INC. 10% NO. MECHANICAL PARKING)

**AREA STATEMENT (ALL AREA ARE IN SQ.M.)**

1. (i) LAND AREA - 18900.37 SQ.M. (270 K. - 00 CH. - 00 S.F.T.)
2. (ii) PHYSICAL LAND AREA - 16302.43 SQ.M. (246 K. - 09 CH. - 38.56 S.F.T.)
3. (iii) KOPT AREA - 285.00 SQ.M. (4 K. - 84 CH. - 7.71 S.F.T.)
4. (iv) PHYSICAL LAND AREA EXCLUDING KOPT AREA - 16017.43 SQ.M. (240 K. - 05 CH. - 30.85 S.F.T.)
5. (v) NO. OF STOREY - G+XII & PARTLY G+XIII
6. (vi) F.A.R. PERMISSIBLE - 2.20 (2.1 + 10% FOR GREEN BUILDING) (CONSIDERING 10% EXTRA F.A.R. FOR GREEN BUILDING)
7. (vii) PERMISSIBLE GROUND COVERAGE (45.00 %) = 7234.84 SQ.M.
8. (viii) PROPOSED GROUND COVERAGE (36.61 %) = 5885.70 SQ.M.
9. (ix) PERMISSIBLE TOTAL COVERED AREA (16017.43 X 2.20) SQ.M. = 35370.35 SQ.M. (EXCLUDING EXEMPTED AREAS & PARKING)
10. (x) PROPOSED TOTAL BUILT UP AREA - 4194.202 SQ.M. (INCLUDING EXEMPTED AREAS & PARKING AREA)

FLOOR	GROSS COV. AREA (SQ.M.)	CUT OUT NET AREA (SQ.M.)	BUILT - UP AREA (SQ.M.)	EXEMPTED AREAS (SQ.M.)	NET FLOOR AREA (C.O.E.)	NET FLOOR AREA (C.O.E.)
(F) FIRE PUMP ROOM	64.48	64.48	64.48	---	64.48	5699.659
(G) GROUND FLOOR	5903.394	10279-10280-10278	5889.819	14.575	5875.244	5699.659
(H) FIRST FLOOR	7768.717-2200.676	7768.717-2200.676	3670.461	4098.256	3670.461	3513.713
(I) 11TH FLOOR (IND. 11TH)	758.717-758.717	758.717-758.717	30048.52	29999.799	758.717	2848.04
(J) 12TH FLOOR (IND. 12TH)	758.717-758.717	758.717-758.717	2279.012	2279.012	758.717	2160.283
TOTAL	43337.187	1394.895	41942.292	1564.137	40378.155	39919.155

**8. (A) CAR PARKING CALCULATION (COVERED):**

FLOOR	NO. OF CARS FOR EXHIBITION	PERMISSIBLE EXEMPTED AREA (SQ.M.)	PROVIDED AREA FOR CAR PARKING
GROUND FLOOR	153419-157 NOS.	187021 + 4675.00	1947.25

**9. EXEMPTED AREA FOR PARKING FROM F.A.R. - 4675.00 SQ.M.**

**10. AT GROUND FLOOR COVERED CAR PARKING - 271 NOS. (INC. 10% NO. MECHANICAL PARKING)**

**11. AT GROUND FLOOR OPEN CAR PARKING - 117 NOS. (INC. 10% NO. MECHANICAL PARKING)**

**12. TOTAL CAR PARKING - 388 NOS. (INC. 10% NO. MECHANICAL PARKING)**

**13. OTHER AREA (IN SQ.M.) ONLY FOR FEES:**

BLOCK	EXEMPTED AREA (SQ.M.)	ROOF GARDEN	F.R.P.	CORPORATE	HOIST TOWER	LIFT SHAFT	TOTAL
OVERALL	1084.16	1072.86	48.24	117.85(2) + 117.85(2) + 10.82	201.13	---	4605.84
(+HV)	+ 2033.16	---	---	---	---	---	---

**14. TOTAL CAR PARKING REQUIRED FOR PART - 381 NOS.**

**15. PROVIDED CAR PARKING - 388 NOS.**

**16. EXCESS CAR PARKING - 7 NOS.**

**17. EXCESS CAR PARKING - 7 NOS.**

**18. EXCESS CAR PARKING - 7 NOS.**

**19. EXCESS CAR PARKING - 7 NOS.**

**20. EXCESS CAR PARKING - 7 NOS.**

**21. EXCESS CAR PARKING - 7 NOS.**

**22. EXCESS CAR PARKING - 7 NOS.**

**23. EXCESS CAR PARKING - 7 NOS.**

**24. EXCESS CAR PARKING - 7 NOS.**

**25. EXCESS CAR PARKING - 7 NOS.**

**26. EXCESS CAR PARKING - 7 NOS.**

**27. EXCESS CAR PARKING - 7 NOS.**

**28. EXCESS CAR PARKING - 7 NOS.**

**29. EXCESS CAR PARKING - 7 NOS.**

**30. EXCESS CAR PARKING - 7 NOS.**

**31. EXCESS CAR PARKING - 7 NOS.**

**32. EXCESS CAR PARKING - 7 NOS.**

**33. EXCESS CAR PARKING - 7 NOS.**

**34. EXCESS CAR PARKING - 7 NOS.**

**35. EXCESS CAR PARKING - 7 NOS.**

**36. EXCESS CAR PARKING - 7 NOS.**

**37. EXCESS CAR PARKING - 7 NOS.**

**38. EXCESS CAR PARKING - 7 NOS.**

**39. EXCESS CAR PARKING - 7 NOS.**

**40. EXCESS CAR PARKING - 7 NOS.**

**41. EXCESS CAR PARKING - 7 NOS.**

**42. EXCESS CAR PARKING - 7 NOS.**

**43. EXCESS CAR PARKING - 7 NOS.**

**44. EXCESS CAR PARKING - 7 NOS.**

**45. EXCESS CAR PARKING - 7 NOS.**

**46. EXCESS CAR PARKING - 7 NOS.**

**47. EXCESS CAR PARKING - 7 NOS.**

**48. EXCESS CAR PARKING - 7 NOS.**

**49. EXCESS CAR PARKING - 7 NOS.**

**50. EXCESS CAR PARKING - 7 NOS.**

**51. EXCESS CAR PARKING - 7 NOS.**

**52. EXCESS CAR PARKING - 7 NOS.**

**53. EXCESS CAR PARKING - 7 NOS.**

**54. EXCESS CAR PARKING - 7 NOS.**

**55. EXCESS CAR PARKING - 7 NOS.**

**56. EXCESS CAR PARKING - 7 NOS.**

**57. EXCESS CAR PARKING - 7 NOS.**

**58. EXCESS CAR PARKING - 7 NOS.**

**59. EXCESS CAR PARKING - 7 NOS.**

**60. EXCESS CAR PARKING - 7 NOS.**

**61. EXCESS CAR PARKING - 7 NOS.**

**62. EXCESS CAR PARKING - 7 NOS.**

**63. EXCESS CAR PARKING - 7 NOS.**

**64. EXCESS CAR PARKING - 7 NOS.**

**65. EXCESS CAR PARKING - 7 NOS.**

**66. EXCESS CAR PARKING - 7 NOS.**

**67. EXCESS CAR PARKING - 7 NOS.**

**68. EXCESS CAR PARKING - 7 NOS.**

**69. EXCESS CAR PARKING - 7 NOS.**

**70. EXCESS CAR PARKING - 7 NOS.**

**71. EXCESS CAR PARKING - 7 NOS.**

**72. EXCESS CAR PARKING - 7 NOS.**

**73. EXCESS CAR PARKING - 7 NOS.**

**74. EXCESS CAR PARKING - 7 NOS.**

**75. EXCESS CAR PARKING - 7 NOS.**

**76. EXCESS CAR PARKING - 7 NOS.**

**77. EXCESS CAR PARKING - 7 NOS.**

**78. EXCESS CAR PARKING - 7 NOS.**

**79. EXCESS CAR PARKING - 7 NOS.**

**80. EXCESS CAR PARKING - 7 NOS.**

**81. EXCESS CAR PARKING - 7 NOS.**

**82. EXCESS CAR PARKING - 7 NOS.**

**83. EXCESS CAR PARKING - 7 NOS.**

**84. EXCESS CAR PARKING - 7 NOS.**

**85. EXCESS CAR PARKING - 7 NOS.**

**86. EXCESS CAR PARKING - 7 NOS.**

**87. EXCESS CAR PARKING - 7 NOS.**

**88. EXCESS CAR PARKING - 7 NOS.**

**89. EXCESS CAR PARKING - 7 NOS.**

**90. EXCESS CAR PARKING - 7 NOS.**

**91. EXCESS CAR PARKING - 7 NOS.**

**92. EXCESS CAR PARKING - 7 NOS.**

**93. EXCESS CAR PARKING - 7 NOS.**

**94. EXCESS CAR PARKING - 7 NOS.**

**95. EXCESS CAR PARKING - 7 NOS.**

**96. EXCESS CAR PARKING - 7 NOS.**

**97. EXCESS CAR PARKING - 7 NOS.**

**98. EXCESS CAR PARKING - 7 NOS.**

**99. EXCESS CAR PARKING - 7 NOS.**

**100. EXCESS CAR PARKING - 7 NOS.**

**101. EXCESS CAR PARKING - 7 NOS.**

**102. EXCESS CAR PARKING - 7 NOS.**

**103. EXCESS CAR PARKING - 7 NOS.**

**104. EXCESS CAR PARKING - 7 NOS.**

**105. EXCESS CAR PARKING - 7 NOS.**

**106. EXCESS CAR PARKING - 7 NOS.**

**107. EXCESS CAR PARKING - 7 NOS.**

**108. EXCESS CAR PARKING - 7 NOS.**

**109. EXCESS CAR PARKING - 7 NOS.**

**110. EXCESS CAR PARKING - 7 NOS.**

**111. EXCESS CAR PARKING - 7 NOS.**

**112. EXCESS CAR PARKING - 7 NOS.**

**113. EXCESS CAR PARKING - 7 NOS.**

**114. EXCESS CAR PARKING - 7 NOS.**

**115. EXCESS CAR PARKING - 7 NOS.**

**116. EXCESS CAR PARKING - 7 NOS.**

**117. EXCESS CAR PARKING - 7 NOS.**

**118. EXCESS CAR PARKING - 7 NOS.**

**119. EXCESS CAR PARKING - 7 NOS.**

**120. EXCESS CAR PARKING - 7 NOS.**

**121. EXCESS CAR PARKING - 7 NOS.**

**122. EXCESS CAR PARKING - 7 NOS.**

**123. EXCESS CAR PARKING - 7 NOS.**

**124. EXCESS CAR PARKING - 7 NOS.**

**125. EXCESS CAR PARKING - 7 NOS.**

**126. EXCESS CAR PARKING - 7 NOS.**

**127. EXCESS CAR PARKING - 7 NOS.**

**128. EXCESS CAR PARKING - 7 NOS.**

**129. EXCESS CAR PARKING - 7 NOS.**

**130. EXCESS CAR PARKING - 7 NOS.**

**131. EXCESS CAR PARKING - 7 NOS.**

**132. EXCESS CAR PARKING - 7 NOS.**

**133. EXCESS CAR PARKING - 7 NOS.**

**134. EXCESS CAR PARKING - 7 NOS.**

**135. EXCESS CAR PARKING - 7 NOS.**

**136. EXCESS CAR PARKING - 7 NOS.**

**137. EXCESS CAR PARKING - 7 NOS.**

**138. EXCESS CAR PARKING - 7 NOS.**

**139. EXCESS CAR PARKING - 7 NOS.**

**140. EXCESS CAR PARKING - 7 NOS.**

**141. EXCESS CAR PARKING - 7 NOS.**

**142. EXCESS CAR PARKING - 7 NOS.**

**143. EXCESS CAR PARKING - 7 NOS.**

**144. EXCESS CAR PARKING - 7 NOS.**

**145. EXCESS CAR PARKING - 7 NOS.**

**146. EXCESS CAR PARKING - 7 NOS.**

**147. EXCESS CAR PARKING - 7 NOS.**

**148. EXCESS CAR PARKING - 7 NOS.**

**149. EXCESS CAR PARKING - 7 NOS.**

**150. EXCESS CAR PARKING - 7 NOS.**

**151. EXCESS CAR PARKING - 7 NOS.**

**152. EXCESS CAR PARKING - 7 NOS.**

**153. EXCESS CAR PARKING - 7 NOS.**

**154. EXCESS CAR PARKING - 7 NOS.**

**155. EXCESS CAR PARKING - 7 NOS.**

**156. EXCESS CAR PARKING - 7 NOS.**

**157. EXCESS CAR PARKING - 7 NOS.**

**158. EXCESS CAR PARKING - 7 NOS.**

**159. EXCESS CAR PARKING - 7 NOS.**

**160. EXCESS CAR PARKING - 7 NOS.**

**161. EXCESS CAR PARKING - 7 NOS.**

**162. EXCESS CAR PARKING - 7 NOS.**

**163. EXCESS CAR PARKING - 7 NOS.**

**164. EXCESS CAR PARKING - 7 NOS.**

**165. EXCESS CAR PARKING - 7 NOS.**

**166. EXCESS CAR PARKING - 7 NOS.**

**167. EXCESS CAR PARKING - 7 NOS.**

**168. EXCESS CAR PARKING - 7 NOS.**

**169. EXCESS CAR PARKING - 7 NOS.**

**170. EXCESS CAR PARKING - 7 NOS.**

**171. EXCESS CAR PARKING - 7 NOS.**

**172. EXCESS CAR PARKING - 7 NOS.**

**173. EXCESS CAR PARKING - 7 NOS.**

**174. EXCESS CAR PARKING - 7 NOS.**

**175. EXCESS CAR PARKING - 7 NOS.**

**176. EXCESS CAR PARKING - 7 NOS.**

**177. EXCESS CAR PARKING - 7 NOS.**

**178. EXCESS CAR PARKING - 7 NOS.**

**179. EXCESS CAR PARKING - 7 NOS.**

**180. EXCESS CAR PARKING - 7 NOS.**

**181. EXCESS CAR PARKING - 7 NOS.**

**182. EXCESS CAR PARKING - 7 NOS.**

**183. EXCESS CAR PARKING - 7 NOS.**

**184. EXCESS CAR PARKING - 7 NOS.**

**185. EXCESS CAR PARKING - 7 NOS.**

**186. EXCESS CAR PARKING - 7 NOS.**

**187. EXCESS CAR PARKING - 7 NOS.**

**188. EXCESS CAR PARKING - 7 NOS.**

**189. EXCESS CAR PARKING - 7 NOS.**

**190. EXCESS CAR PARKING - 7 NOS.**

**191. EXCESS CAR PARKING - 7 NOS.**

**192. EXCESS CAR PARKING - 7 NOS.**

**193. EXCESS CAR PARKING - 7 NOS.**

**194. EXCESS CAR PARKING - 7 NOS.**

**195. EXCESS CAR PARKING - 7 NOS.**

**196. EXCESS CAR PARKING - 7 NOS.**

**197. EXCESS CAR PARKING - 7 NOS.**

**198. EXCESS CAR PARKING - 7 NOS.**

**199. EXCESS CAR PARKING - 7 NOS.**

**200. EXCESS CAR PARKING - 7 NOS.**

**201. EXCESS CAR PARKING - 7 NOS.**

**202. EXCESS CAR PARKING - 7 NOS.**

**203. EXCESS CAR PARKING - 7 NOS.**

**204. EXCESS CAR PARKING - 7 NOS.**

**205. EXCESS CAR PARKING - 7 NOS.**

**206. EXCESS CAR PARKING - 7 NOS.**

**207. EXCESS CAR PARKING - 7 NOS.**

**208. EXCESS CAR PARKING - 7 NOS.**

**209. EXCESS CAR PARKING - 7 NOS.**

**210. EXCESS CAR PARKING - 7 NOS.**

**211. EXCESS CAR PARKING - 7 NOS.**

**212. EXCESS CAR PARKING - 7 NOS.**

**213. EXCESS CAR PARKING - 7 NOS.**

**214. EXCESS CAR PARKING - 7 NOS.**

**215. EXCESS CAR PARKING - 7 NOS.**

**216. EXCESS CAR PARKING - 7 NOS.**

**217. EXCESS CAR PARKING - 7 NOS.**

**218. EXCESS CAR PARKING - 7 NOS.**

**219. EXCESS CAR PARKING - 7 NOS.**

**220. EXCESS CAR PARKING - 7 NOS.**

**221. EXCESS CAR PARKING - 7 NOS.**

**222. EXCESS CAR PARKING - 7 NOS.**

**223. EXCESS CAR PARKING - 7 NOS.**

**224. EXCESS CAR PARKING - 7 NOS.**

**225. EXCESS CAR PARKING - 7 NOS.**

**226. EXCESS CAR PARKING - 7 NOS.**

**227. EXCESS CAR PARKING - 7 NOS.**

**228. EXCESS CAR PARKING - 7 NOS.**

**229. EXCESS CAR PARKING - 7 NOS.**

**230. EXCESS CAR PARKING - 7 NOS.**

**231. EXCESS CAR PARKING - 7 NOS.**

**232. EXCESS CAR PARKING - 7 NOS.**

**233. EXCESS CAR PARKING - 7 NOS.**

**234. EXCESS CAR PARKING - 7 NOS.**

**235. EXCESS CAR PARKING - 7 NOS.**

**236. EXCESS CAR PARKING - 7 NOS.**

**237. EXCESS CAR PARKING - 7 NOS.**

**238. EXCESS CAR PARKING - 7 NOS.**

**239. EXCESS CAR PARKING - 7 NOS.**

**240. EXCESS CAR PARKING - 7 NOS.**

**241. EXCESS CAR PARKING - 7 NOS.**

**242. EXCESS CAR PARKING - 7 NOS.**

**243. EXCESS CAR PARKING - 7 NOS.**

**244. EXCESS CAR PARKING - 7 NOS.**

**245. EXCESS CAR PARKING - 7 NOS.**

**246. EXCESS CAR PARKING - 7 NOS.**

**247. EXCESS CAR PARKING - 7 NOS.**

**248. EXCESS CAR PARKING - 7 NOS.**

**249. EXCESS CAR PARKING - 7 NOS.**

**250. EXCESS CAR PARKING - 7 NOS.**

**251. EXCESS CAR PARKING - 7 NOS.**

**252. EXCESS CAR PARKING - 7 NOS.**

**253. EXCESS CAR PARKING - 7 NOS.**

**254. EXCESS CAR PARKING - 7 NOS.**

**255. EXCESS CAR PARKING - 7 NOS.**

**256. EXCESS CAR PARKING - 7 NOS.**

**257. EXCESS CAR PARKING - 7 NOS.**

**258. EXCESS CAR PARKING - 7 NOS.**

**259. EXCESS CAR PARKING - 7 NOS.**

**260. EXCESS CAR PARKING - 7 NOS.**

**261. EXCESS CAR PARKING - 7 NOS.**

**262. EXCESS CAR PARKING - 7 NOS.**

**263. EXCESS CAR PARKING - 7 NOS.**

**264. EXCESS CAR PARKING - 7 NOS.**

**265. EXCESS CAR PARKING - 7 NOS.**

**266. EXCESS CAR PARKING - 7 NOS.**

**267. EXCESS CAR PARKING - 7 NOS.**

**268. EXCESS CAR PARKING - 7 NOS.**

**269. EXCESS CAR PARKING - 7 NOS.**

**270. EXCESS CAR PARKING - 7 NOS.**

**271. EXCESS CAR PARKING - 7 NOS.**

**272. EXCESS CAR PARKING - 7 NOS.**

**273. EXCESS CAR PARKING - 7 NOS.**

**274. EXCESS CAR PARKING - 7 NOS.**

**275. EXCESS CAR PARKING - 7 NOS.**

**276. EXCESS CAR PARKING - 7 NOS.**

**277. EXCESS CAR PARKING - 7 NOS.**

**278. EXCESS CAR PARKING - 7 NOS.**

**279. EXCESS CAR PARKING - 7 NOS.**

**280. EXCESS CAR PARKING - 7 NOS.**

**281. EXCESS CAR PARKING - 7 NOS.**

**282. EXCESS CAR PARKING - 7 NOS.**

**283. EXCESS CAR PARKING - 7 NOS.**

**284. EXCESS CAR PARKING - 7 NOS.**

**285. EXCESS CAR PARKING - 7 NOS.**

**286. EXCESS CAR PARKING - 7 NOS.**

**287. EXCESS CAR PARKING - 7 NOS.**

**288. EXCESS CAR PARKING - 7 NOS.**

**289. EXCESS CAR PARKING - 7 NOS.**

**290. EXCESS CAR PARKING - 7 NOS.**

**291. EXCESS CAR PARKING - 7 NOS.**

**292. EXCESS CAR PARKING - 7 NOS.**

**293. EXCESS CAR PARKING - 7 NOS.**

**294. EXCESS CAR PARKING - 7 NOS.**

**295. EXCESS CAR PARKING - 7 NOS.**

**296. EXCESS CAR PARKING - 7 NOS.**

**297. EXCESS CAR PARKING - 7 NOS.**

**298. EXCESS CAR PARKING - 7 NOS.**

**299. EXCESS CAR PARKING - 7 NOS.**

**300. EXCESS CAR PARKING - 7 NOS.**

**301. EXCESS CAR PARKING - 7 NOS.**

**302. EXCESS CAR PARKING - 7 NOS.**

**303. EXCESS CAR PARKING - 7 NOS.**

**304. EXCESS CAR PARKING - 7 NOS.**

**305. EXCESS CAR PARKING - 7 NOS.**

**306. EXCESS CAR PARKING - 7 NOS.**

**307. EXCESS CAR PARKING - 7 NOS.**

**308. EXCESS CAR PARKING - 7 NOS.**

**309. EXCESS CAR PARKING - 7 NOS.**

**310. EXCESS CAR PARKING - 7 NOS.**

**311. EXCESS CAR PARKING - 7 NOS.**

**312. EXCESS CAR PARKING - 7 NOS.**

**313. EXCESS CAR PARKING - 7 NOS.**

**314. EXCESS CAR PARKING - 7 NOS.**

**315. EXCESS CAR PARKING - 7 NOS.**

**316. EXCESS CAR PARKING - 7 NOS.**

**317. EXCESS CAR PARKING - 7 NOS.**

**318. EXCESS CAR PARKING - 7 NOS.**

**319. EXCESS CAR PARKING - 7 NOS.**

**320. EXCESS CAR PARKING - 7 NOS.**

**321. EXCESS CAR PARKING - 7 NOS.**

**322. EXCESS CAR PARKING - 7 NOS.**

**323. EXCESS CAR PARKING - 7 NOS.**

**324. EXCESS CAR PARKING - 7 NOS.**

**325. EXCESS CAR PARKING - 7 NOS.**

**326. EXCESS CAR PARKING - 7 NOS.**

**327. EXCESS CAR PARKING - 7 NOS.**

**328. EXCESS CAR PARKING - 7 NOS.**

**329. EXCESS CAR PARKING - 7 NOS.**

**330. EXCESS CAR PARKING - 7 NOS.**

**331. EXCESS CAR PARKING - 7 NOS.**

**332. EXCESS CAR PARKING - 7 NOS.**

**333.**